

## holographix<sup>®</sup>

2x concealed audio loudspeakers  
**5600K01**

### Installation Instructions

#### holographix - specifications

5600K01-WE holographix speakers, in-ceiling round pair, white

Frequency Range: 90Hz - 20kHz in room response

Power Handling: Min. 20 Watts - Max. 40 Watts  
RMS amplifier power

Sensitivity: 87dB for 2.83 volts at 1m

Impedance: Nominally 8 ohms

Dimensions: 95mm (3-3/4") diameter x  
108mm (4-1/4") deep

Mounting Dia. 83mm (3-1/4")

Weight: 0.5 kg (1.1 lb) each

#### Step 1

Check intended in-ceiling location for any obstructions, such as electrical wiring, stud work or air conditioning ducts before cutting any holes. Also check that there is enough ceiling space for the speaker enclosure.

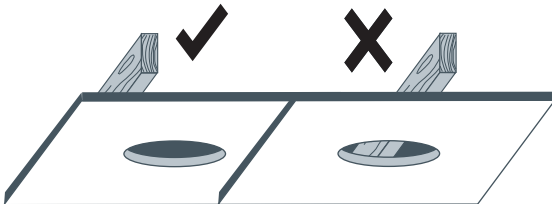

#### Per channel wiring diagram

1 speaker  
8 ohms



2 speakers  
series  
4 ohms



3 speakers  
series  
2.7 ohms



4 speakers  
series/parallel  
8 ohms



6 speakers  
series/parallel  
5.4 ohms



8 speakers  
series/parallel  
4 ohms



12 speakers  
series/parallel  
6 ohms



16 speakers  
series/parallel  
8 ohms



Specifications and instructions are supplied for general information only and may change without notice. There are no user serviceable parts. If you require further assistance please contact Clipsal Technical Support. Designed and engineered by Krix Loudspeakers Pty Ltd. Manufactured in China.

## Step 2

Use the cut out template from this instruction sheet to draw the required cut-out circle onto the ceiling.

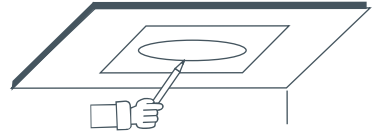

## Step 3

[A] Drill a small hole in the centre of the marked cut-out and then using a fine-tooth gyprock saw, cut toward the line and cut out the circle. Remove the waste piece. Or [B] Using an 83mm (3 1/4') holesaw and a power drill, cut out the marked area. Insert the speaker to make sure the hole is the right size. Enlarge the hole if required.

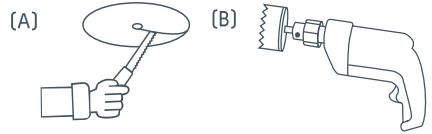

### CAUTION

Use care when cutting into walls or ceilings. You could come in contact with dangerous voltages from installed wiring.

## Step 4

Pull the speaker cable through the opening and strip approximately 10mm (0.39") of the insulation to expose the copper wire. Insert the bare wires into the speaker connections. Observe the correct polarity; make sure the corresponding red (+) and black (-) amplifier terminals are connected to the corresponding speaker terminals.



## Step 5

Push the two metal flaps against the outer edge of the enclosure. Insert the speaker into the hole. Do not release the flaps until they are within the hole. Then gently push the speaker until it rests flush with the ceiling. Grip the outer edge of the front face and turn it clockwise approximately half a turn to engage the two metal flaps.

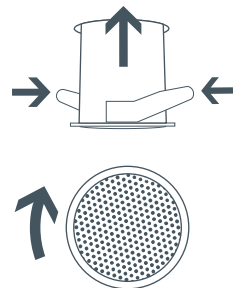

If you have installation questions contact Clipsal Technical Support at the number on the back page of this instruction. For warranty questions, refer to the warranty form that is provided with this product.

## Removing the Speaker

To remove the speaker, grip the outer edge of the front face and turn it counter clockwise approximately one half turn. Using a flat blade screwdriver, carefully lever the front face of the speaker away from the ceiling or wall. Continue turning counter clockwise while gently pulling on the speaker to 'unwind' it from the hole.

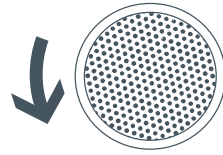

Use the template below to trace the required cut-out onto the ceiling.

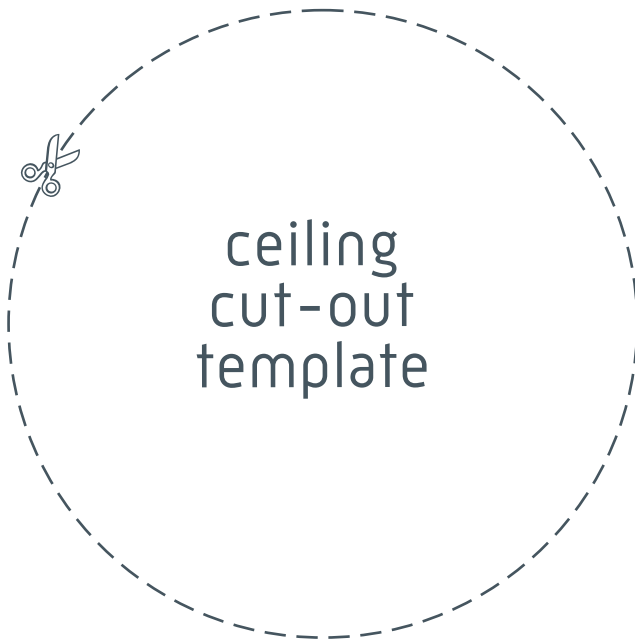

Cut out diameter: 83mm (3 1/4")

If you have installation questions, contact Clipsal Technical Support at one of the numbers below. For warranty questions, refer to the warranty form that is provided with this product.

<b>Clipsal Technical Support Contact Numbers</b>	
<b>Australia</b>	1300 722 247 (CIS Technical Support Hotline)
<b>New Zealand</b>	0800 888 219 (CIS Technical Support Hotline)
<b>Northern Asia</b>	+852 2484 4157 (Clipsal Hong Kong)
<b>South Africa</b>	011 314 5200 (C-Bus Technical Support)
<b>Southern Asia</b>	+603 7665 3555 Ext. 236 or 242 (CIS Malaysia)
<b>United Kingdom</b>	0870 608 8 608 (Schneider Electric Support)

**Clipsal CIS Technical Support email: [cis.support@clipsal.com.au](mailto:cis.support@clipsal.com.au)**

---

## **Clipsal Australia Pty Ltd**

A member of Schneider Electric

**Contact us: [clipsal.com/feedback](https://www.clipsal.com/feedback)**

**National Customer Care Enquiries:**

**Tel 1300 2025 25**

**Fax 1300 2025 56**

**clipsal.com**

Clipsal Australia Pty Ltd reserves the right to change specifications, modify designs and discontinue items without incurring obligation and whilst every effort is made to ensure that descriptions, specifications and other information in this catalogue are correct, no warranty is given in respect thereof and the company shall not be liable for any error therein.

© Clipsal Australia Pty Ltd. The identified trademarks and copyrights are the property of Clipsal Australia Pty Ltd unless otherwise noted.